

SERVICE ET MANUFACTURE DE LUNETTES

---

L'INGÉNIEUR CHEVALLIER  
1740

---

FROM PRECISION INSTRUMENTS...  
TO CUSTOM-MADE READY-TO-WEAR

---

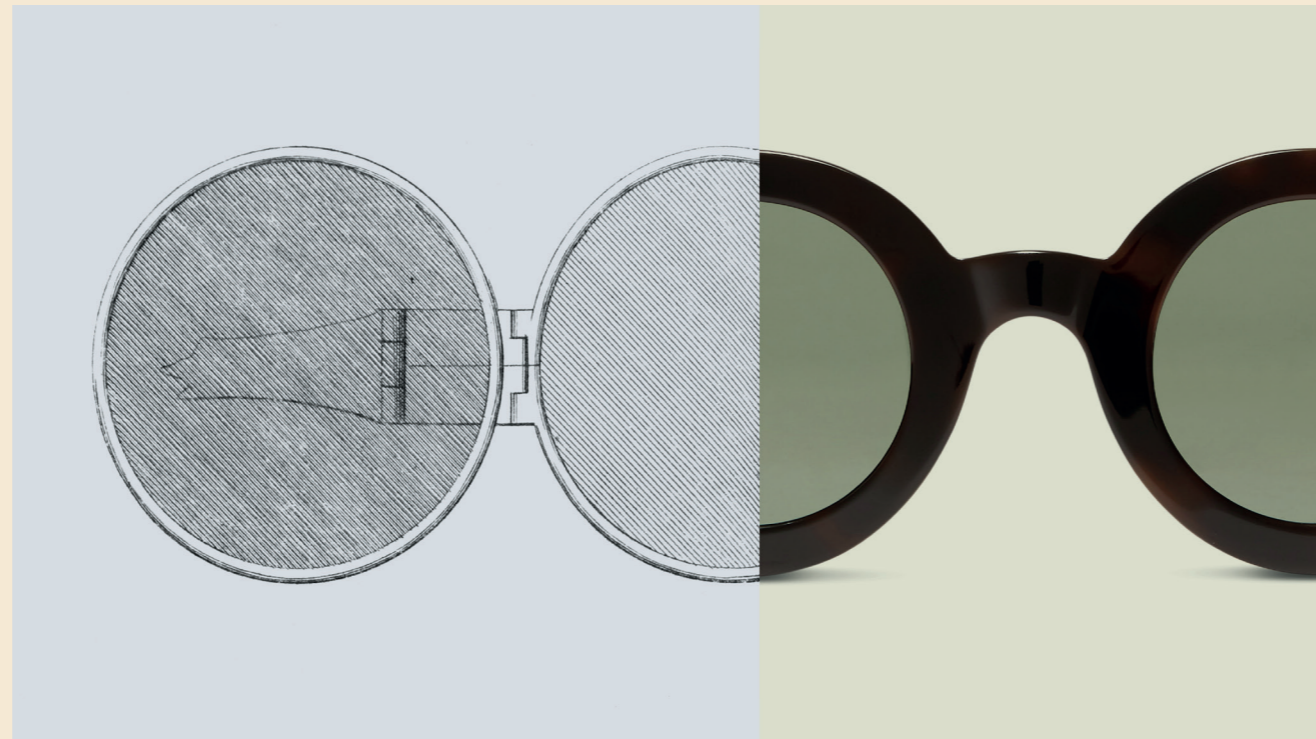

*“A serious optician is not a merchant. He is a technician,  
an advisor, a craftsman rather than a shop keeper.  
The value of his technique, his advice, and his skill are  
to be examined concurrently with his prices.”*

---

L'INGÉNIEUR CHEVALLIER  
*Lunetier de qualité (1950)*

THE EASE  
OF READY-TO-WEAR,  
THE LUXURY  
OF CUSTOM-MADE

L'Ingénieur Chevallier proudly asserts its commitment to excellence, not only in the selection of frames, but also in its professionalism and high standards in terms of service.

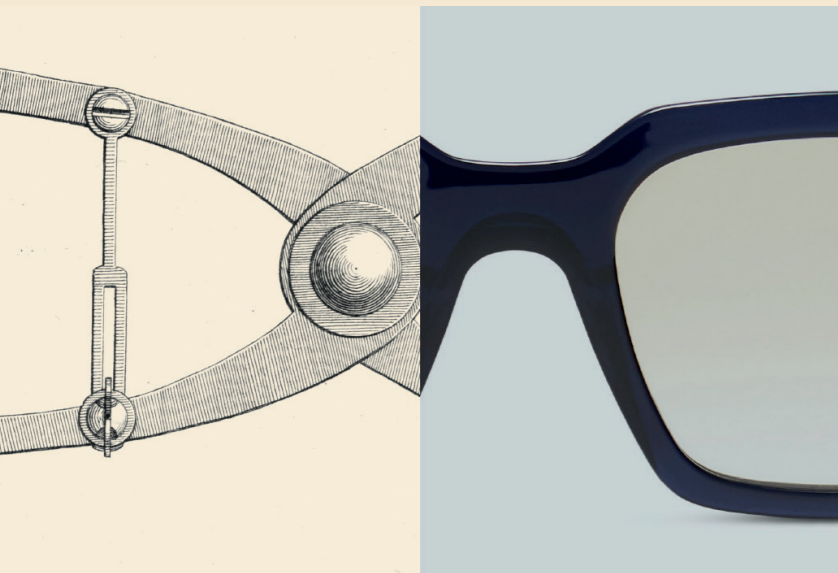

PERMANENT  
COLLECTIONS

L'Ingénieur Chevallier offers a selection of entirely handmade frames, sometimes edited in limited series and regularly renewed. Some exclusive L'Ingénieur Chevallier-stamped models are produced in our workshops in Paris.

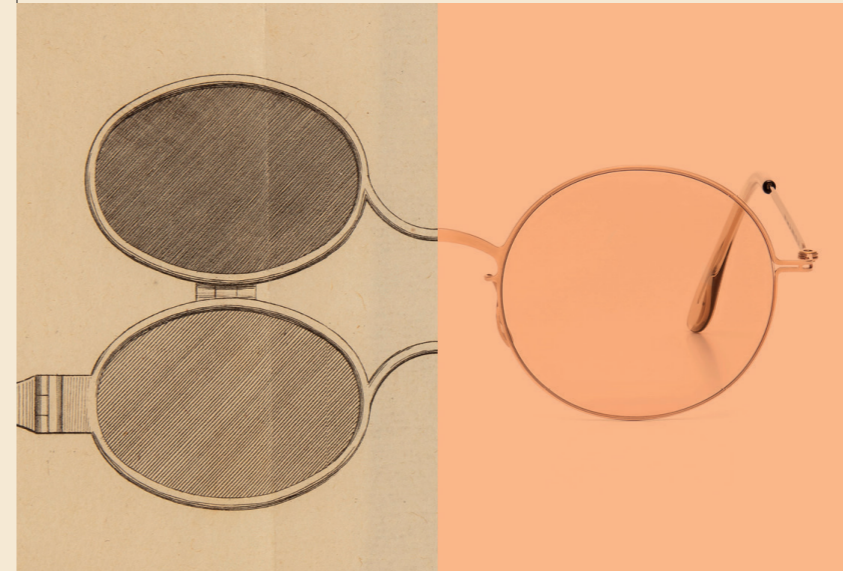

EXCLUSIVE  
MINI-SERIES

Made by the finest craftsmen in the world in collaboration with L'Ingénieur Chevallier, certain frames are available in ultra-limited quantities in an effort to offer our customers unique pieces that cannot be found anywhere else but in our boutiques.

Our team of passionate professionals, trained in the Bonnet family's workshops, takes all the time necessary to ensure optimum comfort. Each pair of glasses is adjusted by taking into account the morphological specificities of its owner: the distance between the lens and the eye, adjustments of the inclinations and curves of the temples, the fit of the nose... a number of points that will surprise many.

MORPHOLOGICAL  
FITTING

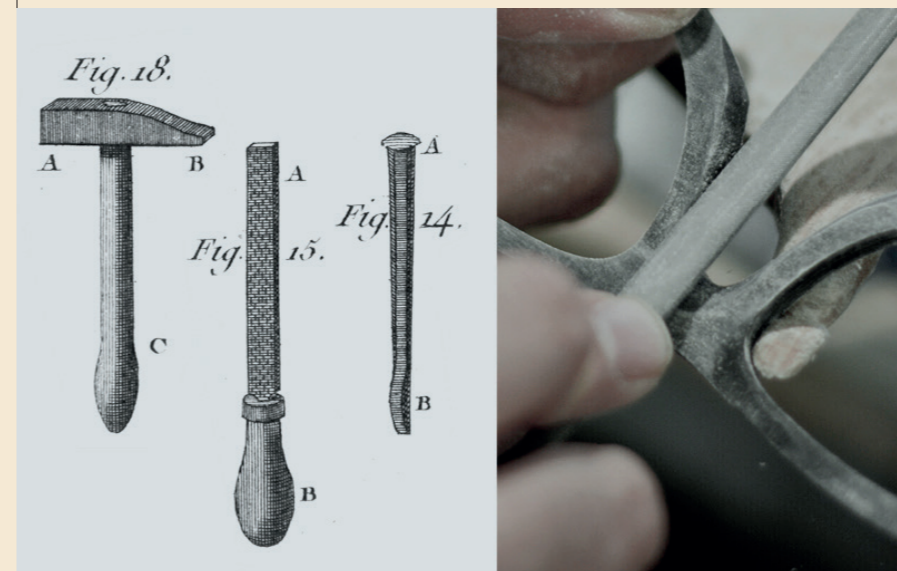
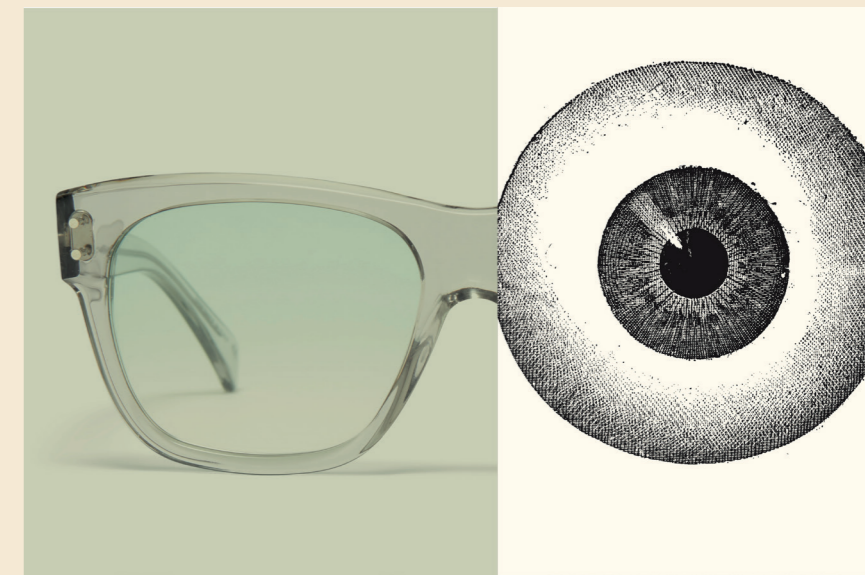

AFTER

Servicing or repairs? Throughout the life of the spectacles, there will always be an Ingénieur at your disposal to repair, re-adjust, repolish, etc.

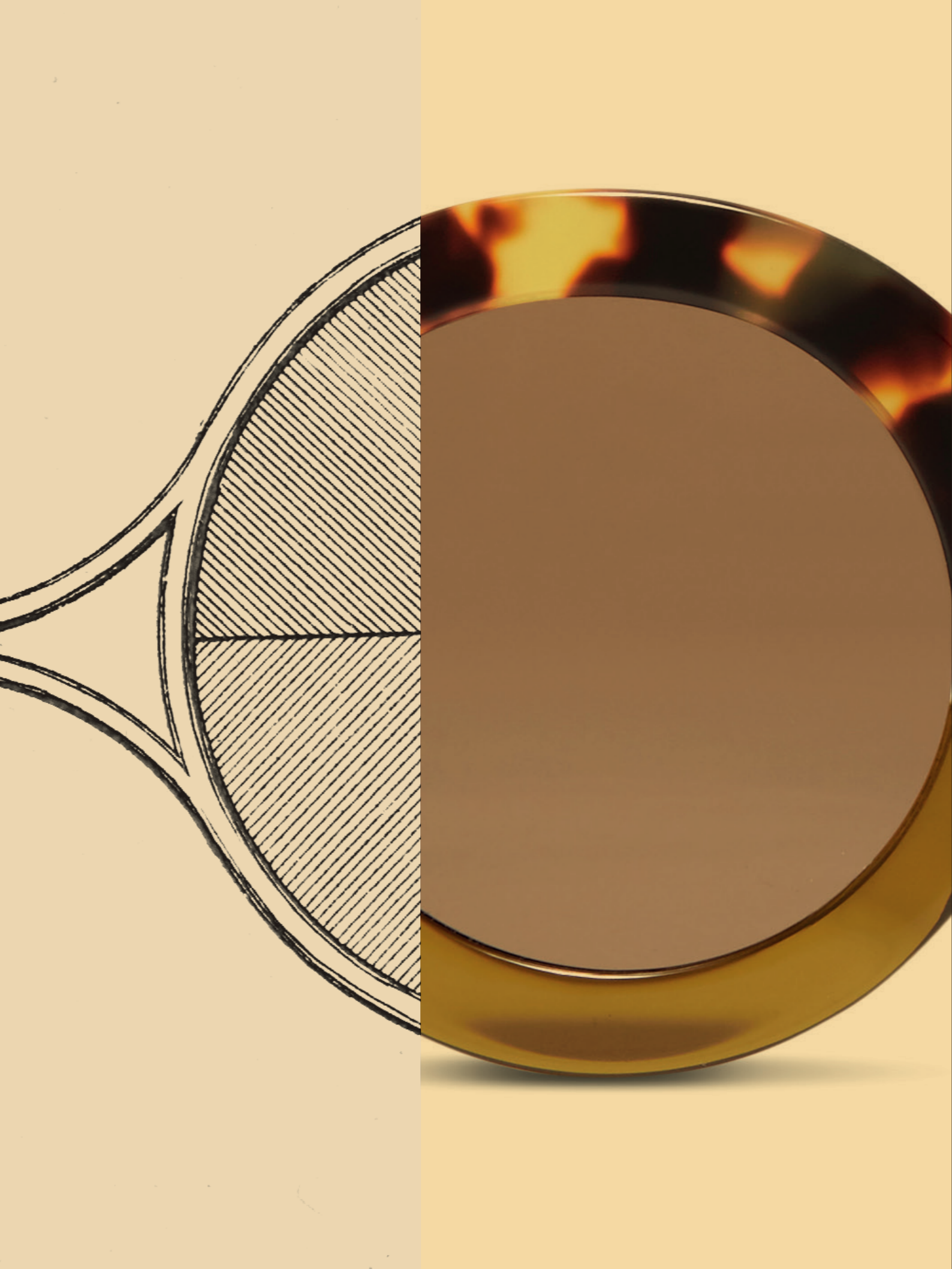

---

## IN SEARCH OF THE UNIQUE

---



Selecting the most beautiful frames  
in the world and showcasing them:  
as conceived by L'Ingénieur Chevallier,  
becomes almost an art!

**Solid gold, silver, titanium, horn, bio-acetate...**

We have gone to the four corners of the world to find the best craftsmen, far from standardized factories. We have chosen human-sized manufactures **where the machine will never replace the gesture of the hand**. The industry is already saturated, our job therefore is to make sure that each pair of glasses is a subject.

We have scoured a great many collections **in search of the rare pearl, the perfect design**, innovative, funky, traditional or sexy. We have forged links with exceptional designers, passionate, committed, and respectful of their know-how and the world they live in.

We are modern optician-eyewear makers, concerned with **combining respect for the past and the demands of the future**. Our profession is evolving and our tools are increasingly high-performance: L'Ingénieur Chevallier offers both **the best craftsmanship and contemporary technologies**.

---

## A MODERN CONCEPT IN A HISTORIC BOUTIQUE

---

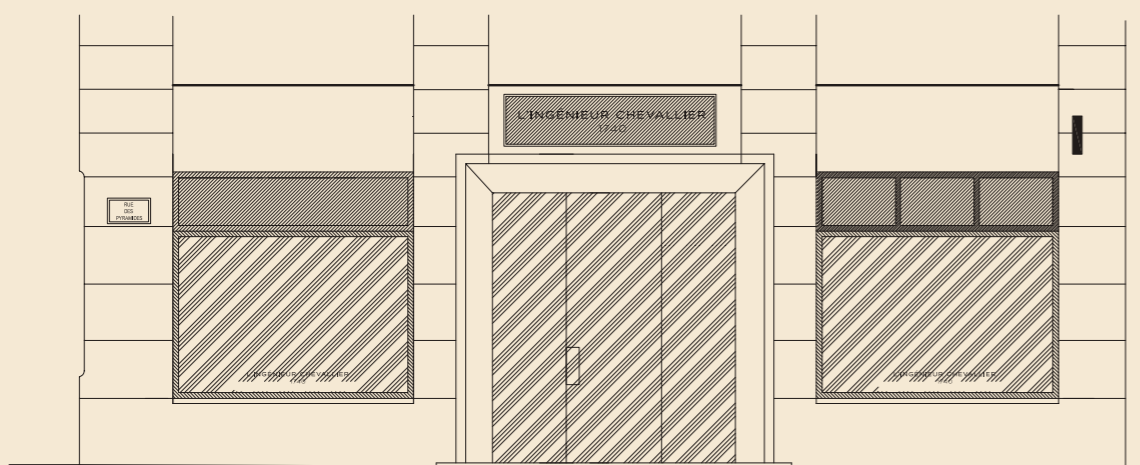

*L'Ingénieur Chevallier is no longer, long live L'Ingénieur Chevallier!* To give new life to the oldest eyewear manufacturer in Paris, that is the gamble made by the Bonnet family in taking over L'Ingénieur Chevallier.

The space has been completely redesigned, thanks to the talent of designer **Pierre Bonnefille**, a *Maitre d'Art* who brought a singular and poetic approach. In the new boutique on the rue des Pyramides, lighting, stone, wood, leather, brushed steel, and mineral nuances create an atmosphere that is far from youth-oriented or museum-like. In order not to disrupt the selection protocol, the frames are hidden from view in drawer cabinets decorated with patinated tulle prints.

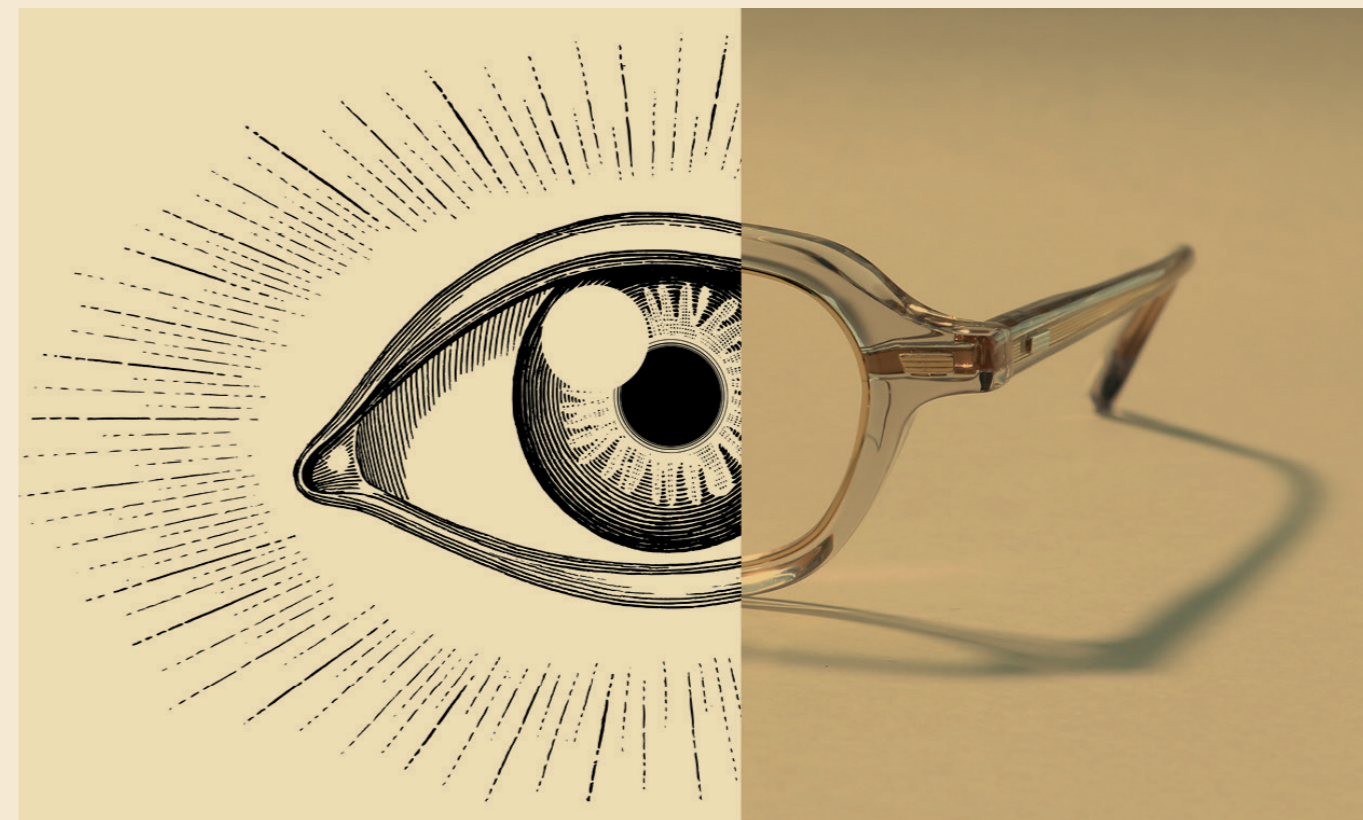

*Choosing a pair  
of eyeglasses  
is now unlike  
any other  
experience...*

Committed to remaining true to its reputation, L'Ingénieur Chevallier uses the **latest generation of optometry instruments**, and it stands out for elegant frame collections, free of designer labels or logos. A team trained in bespoke practices assists each client in finding their pair.

Therefore, all our pieces combine the precision of technology with the skill of the hand... Offering frames handcrafted in very small series by exceptional artisans, choosing the best-performing and most suitable lenses for each client, and ensuring that the object be perfectly adjusted to its owner's face: L'Ingénieur Chevallier brings together the best of both worlds and **invents custom-made ready-to-wear**.

---

L'INGÉNIEUR'S  
SELECTION

---

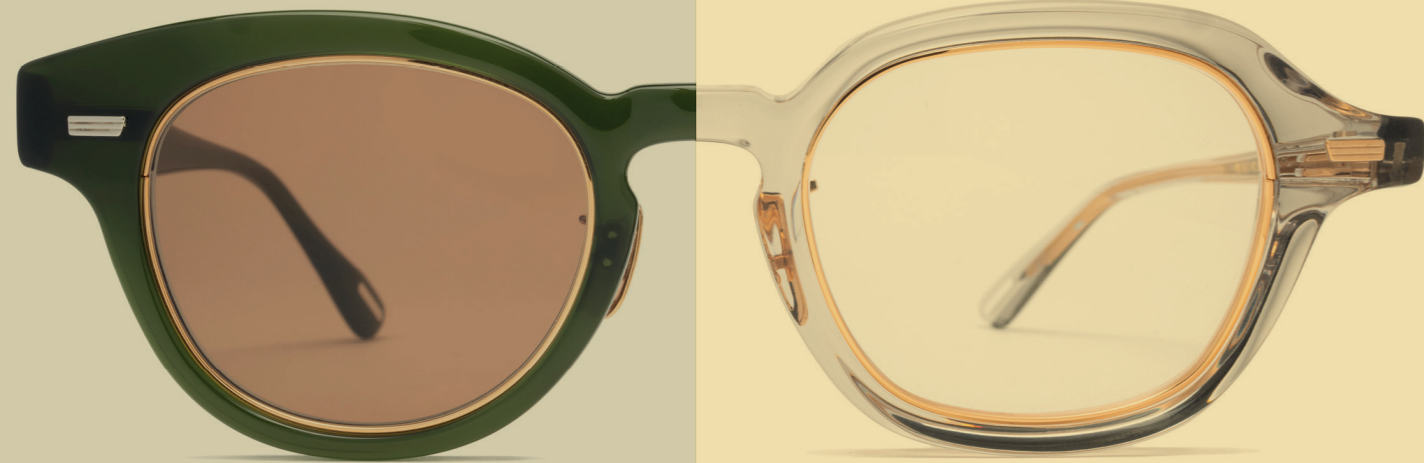

---

BECAUSE  
IT WAS PIERRE,  
BECAUSE  
IT WAS FRANCK...

---

FRANCK BONNET

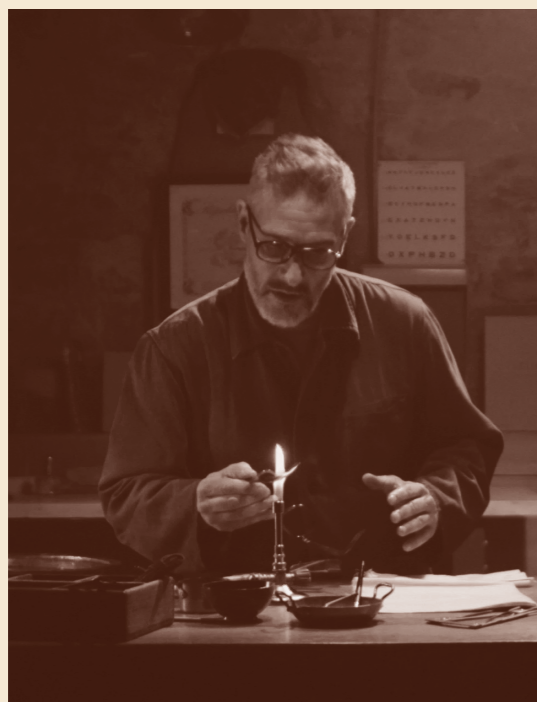

These two were made for each other. The same passion for the best-looking eyewear, the same respect for the ancestral gestures of unique know-how, and the same will to never compromise on quality - Pierre Golendorf and Franck Bonnet found each other. Their meeting was not accidental: since childhood, Franck Bonnet, head of Maison Bonnet, had admired the legendary boutique on the rue des Pyramides. As for Pierre Golendorf, when he decided to sell L'Ingénieur Chevallier he refused to give in to the sirens of large groups and foreign investors. He preferred a man of the trade, a committed craftsman in whom he sensed a profound desire to perpetuate a tradition of exceptional eyewear manufacturers. The meeting of the old and new owners of L'Ingénieur Chevallier.

PIERRE GOLENDORF



**FRANCK BONNET,**  
why did you choose  
L'Ingénieur Chevallier?

When I was a kid and I used to go to the shop with my father to deliver glasses, I was fascinated by the ivory and tortoiseshell binoculars and the silver guilloche lorgnons in the showcases. And those beautiful frames, what memories... I never would have imagined one day saying «This is my place».

Also, there is a gap to be filled between the full bespoke of Maison Bonnet and what you can find on any street corner. With L'Ingénieur Chevallier we are applying bespoke rituals to ready-to-wear in order to offer the perfect ergonomics to which every eyeglass wearer is entitled.

**FRANCK BONNET,**  
how do you see the new life of  
L'Ingénieur Chevallier?

As passionate curators, we go to the four corners of the world to find our frames, in the best workshops, the most competent in their speciality - whether it's horn, gold, silver or acetate - and we have our lenses made by the best optics manufacturers. In the boutique, our glasses are adjusted by les Ingénieurs trained in our workshops, according to the specificities of each face. The same as with custom-made frames!

**PIERRE GOLENDORF,**  
why did you choose  
Franck Bonnet?

Have you seen his look? Simple chore jacket, small pair of round glasses, always smiling, relaxed... I liked that! Besides, who doesn't know his family's reputation? For me, it's the only house intimately linked to Art...

The Bonnets correspond exactly to what I was looking for: the best in terms of craftsmanship and the most professional in the optical field. For me, there is no other eyewear maker that can match L'Ingénieur.

**PIERRE GOLENDORF,**  
how do you imagine the new  
Ingénieur Chevallier?

I don't have to imagine it. I have been a custodian; Franck is a visionary, I know L'Ingénieur is on its way to a renaissance. The spirit will be the same, handmade frames in beautiful materials and a passionate team of professionals. I was looking for that know-how that's so particular, for that state of mind too. I wanted my successor to be able to transmit a real art of living, to understand, respect, and make the brand evolve. When you love beautiful things, you seek out fine establishments. I could think of no others than the Bonnets to perpetuate a profession that I have practiced with passion for over thirty years. It's up to them now!

# THE OLDEST OPTICIAN IN PARIS: A LITTLE HISTORY



Gabriel Augustin Chevallier's grandfather, the first optician in Paris, is set up in the Tour de l'Horloge du Palais by the King himself.



L'Ingénieur Chevallier publishes Le conservateur de la vue, which remains a reference book. In appendix, he adds the catalog of the optical objects sold in the store.



Jean Gabriel Augustin Chevallier's great rival, his namesake Charles Chevalier, designs Nicéphore Niepce's first photographic camera.



L'Ingénieur Chevallier's efforts to improve his optical devices are judged "worthy of praise" by the Academy of Sciences, and he is awarded another bronze medal.

1740

1810

1825

1834

1807

Jean Gabriel Augustin Chevallier invents the microscope. He supplies optical equipment to astronomers, mathematicians, engineers, and some of the greatest scientists.



1823

Among the numerous gold medals awarded him by the Academy of Sciences, L'Ingénieur Chevallier receives one for his achromatic lens.



1827

L'Ingénieur Chevallier, official optician to the King, is awarded a bronze medal by the Academy of Sciences for several of his optical and measurement instruments including the thermometer and the barometer.



1838

Using the two achromatic lenses purchased from the Chevalliers, Daguerre makes «Boulevard du Temple», the first photograph of a human being, immortalizing a shoeshine boy and his customer.



1847

With the invention of the solar microscope, L'Ingénieur Chevallier is once again rewarded with a gold medal from the Academy of Sciences.



1878

L'Ingénieur Chevallier transforms the opera monocular into opera glasses. Mother-of-pearl, ivory, tortoiseshell: nothing is too good for this theater accessory the luxury of which is equaled only by its elegance.



1901

The Avizard brothers put an end to years of rivalry and merge the two best opticians in Paris, L'Ingénieur Chevallier and La Providence Chevalier. The new store sets up shop on the right bank.



1863

L'Ingénieur Chevallier designs the opera monocular, which becomes all the rage among regulars of the finest Parisian venues.



1891

L'Ingénieur Chevallier becomes the official optician of the Army and Navy. He supplies them with optical and precision instruments, «binoculars, compasses, sextants, and other instruments», as indicated in the Almanach du Commerce et de l'Industrie.

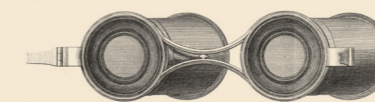

2021

L'Ingénieur Chevallier chooses the Bonnet family to write the next chapter of its history. It is heir to a long tradition of French Art Craftsmen, elevated to the rank of "Maître d'Art" by the Ministry of Culture, labeled a Living Heritage Company, and specializing in bespoke eyewear made of genuine tortoiseshell. The Bonnet family accepts to take over L'Ingénieur Chevallier with the determination to restore its former prestige.

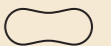

---

# THE NEW INGÉNIEURS

---

## PHOTO DE GROUPE

### **MATHIEU GUILLAUMON-HOMS**

General Manager of l'Ingénieur Chevallier

Trained as an optician, Mathieu Guillaumon-Homs is a former student of the Meilleurs Ouvriers de France school in eyewear. In 2014, he created his own custom frame workshop prior to taking over the management of an exclusive maintenance and restoration department for a major Parisian optician.

In 2018, he returned to his first love, the manufacturing of custom frames.

As a highly involved actor in the prestige eyewear market, Mathieu Guillaumon-Homs has been chosen by Franck Bonnet to manage l'Ingénieur Chevallier.

### **MATTHIEU MAITRE**

Manager of the Paris Vertbois boutique

At the age of 16, Matthieu Maitre already knew that he would choose an art-related profession. Jeweler, watchmaker...? After some hesitation he discovered eyewear: it was a revelation. Very quickly, his creations made a splash.

They opened a door that led to a passionate eyewear manufacturer who entrusted him with the responsibility for custom-made lenses and passed the demand for excellence on to him. After training in the Bonnet family's workshops, his dream of becoming an art craftsman came true.

Today, Matthieu Maitre wants to bring his creativity, his experience of faces, and his expertise in eyewear to L'Ingénieur Chevallier in order to develop custom-made ready-to-wear.

### **MARGAUX CHIFFOLEAU**

Manager of the Paris Pyramides boutique

Having been attracted at a very young age by the creative aspect of the eyewear profession, she trained in Paris with a renowned optician where she learned how to enhance a face and acquired specialized knowledge in eyewear styles. She completed her apprenticeship with a dual degree in economics and optometry which led her to assume the management of the visual health departments of the various opticians for which she worked.

### **PIERRE CHAUMONT**

Right from the start, Pierre Chaumont chose to train in the various facets of the optical business, from sales to design to paramedical issues. He specializes in frame repair and lens assembly, and is in charge of the workshops in the four stores for which he works.

Franck Bonnet and Mathieu Guillaumon-Homs spotted this passionate young man and decided to integrate him in the L'Ingénieur Chevallier team where he can share his know-how and inventiveness.



SERVICE ET MANUFACTURE DE LUNETTES

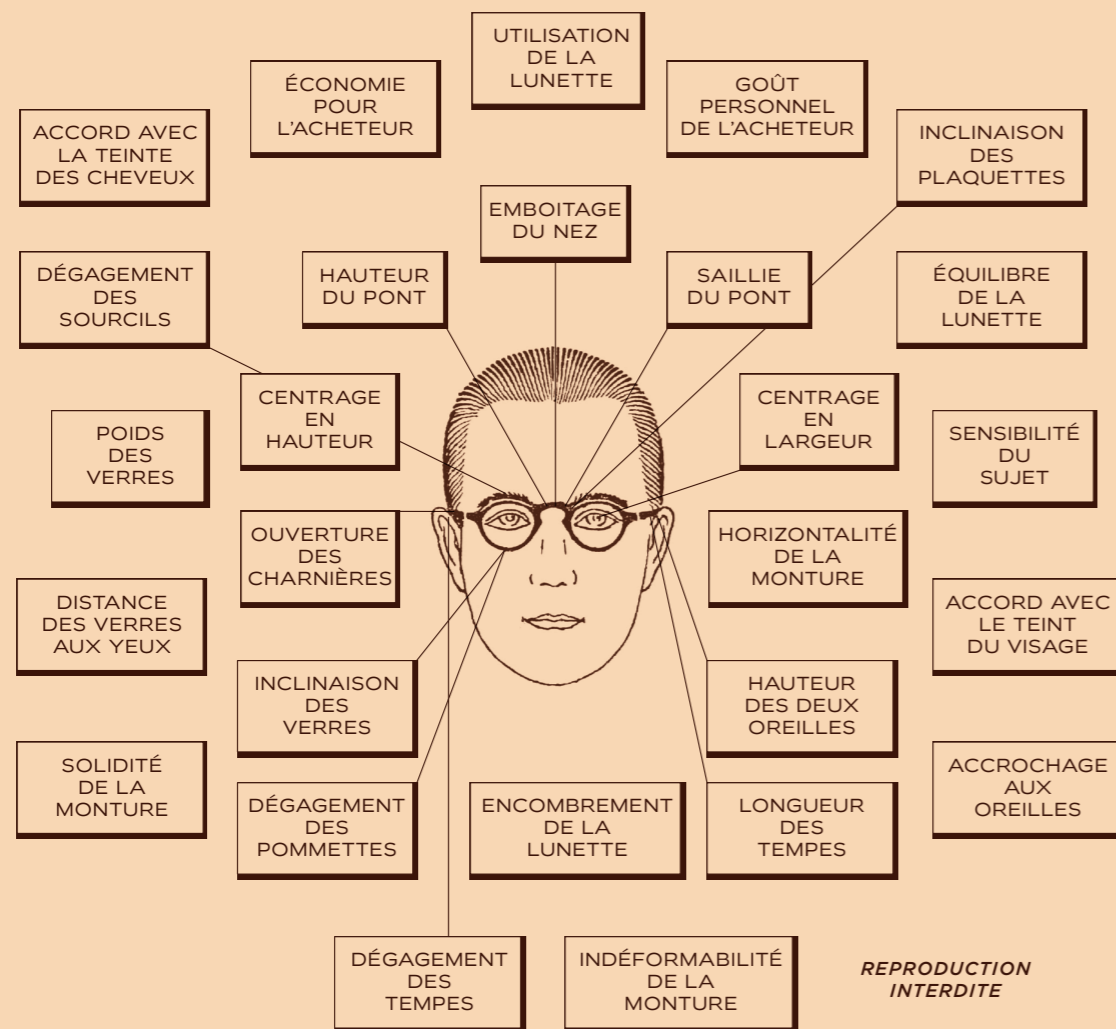

CE QUE NOUS CONSIDÉRONS SANS  
QUE VOUS LE SACHIEZ.

L'INGÉNIEUR CHEVALLIER  
1740

## CONTACT

### PYRAMIDES

17, RUE DES PYRAMIDES PARIS 1<sup>ER</sup>  
PYRAMIDES@INGENIEURCHEVALLIER.COM  
+ 33 1 42 60 74 64

The historic address! In the heart of Paris, between the Louvre and the Opera. Burnished lacquer vitrines for a "mirrorless mirror" effect, a bright and warm interior, an ultra-modern optometry department, and collections that will make you want to collect.

And very soon:

### VERTBOIS

16, RUE DU VERTBOIS PARIS 3<sup>E</sup>  
VERTBOIS@INGENIEURCHEVALLIER.COM  
+ 33 1 88 40 23 50

Heir to the tradition of cultural and artistic innovation of the Institut des Arts & Métiers, the Vertbois district has become the site of the new creative and cultural scene, a synthesis of a contemporary art of living. It was therefore an obvious choice for l'Ingénieur Chevallier to open our second Parisian location there!

To be continued...

WWW.INGENIEURCHEVALLIER.COM



@ingenieurchevallier



@ingenieurchevallier

